

How to make an Origami Swan

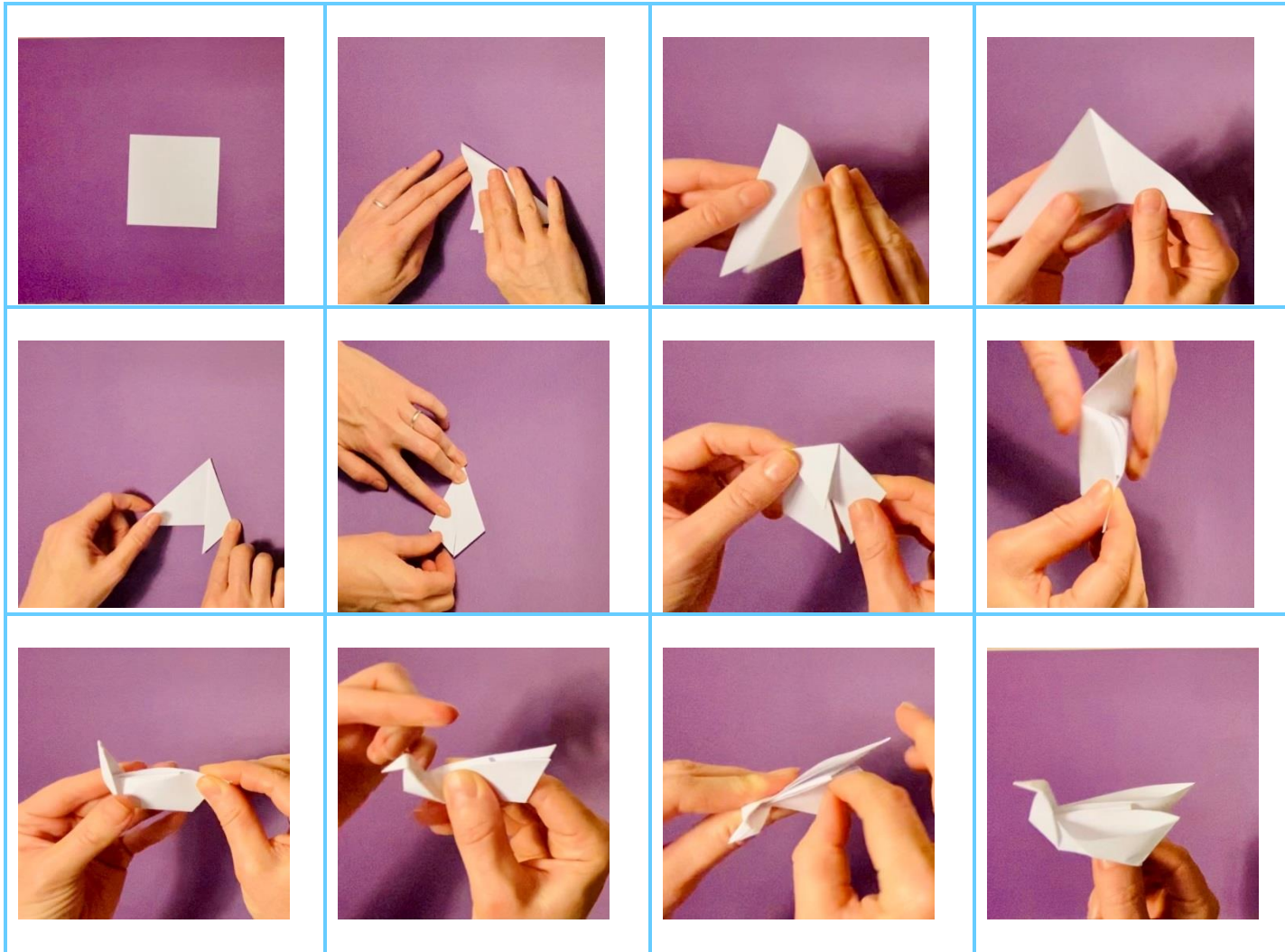

Why is this maths?

Origami is a pattern of creases. If you take your origami swan and unfold it you will find the maths secret – the creases that determine how the paper should fold and what shape it will make.

We can discover maths:

- where the lines lie across each other
- in the direction of the creases
- in the angles that are formed

Follow the instructional video at: mathsontoast.org.uk/festivemaths

For more fun activities visit www.mathsontoast.org.uk

Don't forget to share your creations and comments on Twitter, Facebook or Instagram tagging @mathsontoast using #positiveaboutmaths